

INTELLIGENT NET-DVR WITH DVD BACK-UP & SMART HDD MANAGER



DIGITAL VIDEO RECORDER

WatchNET

- 4, 8 & 16 - Channel Color Models
- Digital Video Recorder
- 25/30 IPS Recording per Channel (PAL/NTSC)
- Simultaneous live display, recording, playback, archive and remote transmission
- Internal DVD/CD writer
- PTZ Control
- Remote Operation via LAN, WAN and Internet
- Audio Recording Capability on each Channel
- Mouse Control on 16 channel DVR's



WatchNET New E-Series dvr lineup is truly state of the art. These compact digital video / audio recorders are sleek in design with a low-profile case that will outperform the competition. The design is not only compact but also has the ability to internally hold up to 6 hard drives for long-term storage. E-series dvr has a broad appeal, as it is both easy to install, program as well as being extremely user-friendly in application. The rugged design and construction of the hardware allows for a durable product that is well ventilated, ultimately promoting a maintenance free long lasting system.

WatchNET E-Series dvr allows for simultaneous Live Display, Record, Playback, Archive and Remote Transmission. All images have encoded digital date and time stamp.

WatchNET E-Series dvr have high performance, real-time video capture and playback. The new H. 264, hardware compression captures and processes up to 480 frames (NTSC) in a single second. Each camera / channel can produce 30 frames (images) in each second but can also be scaled down to increase recording length ie. (Extend overall recorded time on each Hard Drive).

WatchNET E-Series dvr controls and manipulates both internal and external alarm inputs and outputs. Either through input sensors or motion within the video stream the Watchnet system can output alarms for instant notification. Rapid Search features allow for instant retrieval of recorded data on all channels or smart search by selecting only motion detection or alarm triggers. Watch live camera feed with our picture in picture function during playback.

With **WatchNET** E-Series dvr has a external keyboard can be used to control PTZ's, matrix controls and multiple dvr's. All controls are available over the network also.

Video / Audio data can easily be backed up and outputted to DVD/CD or USB key, that can be played back on any PC, make AVI files or take snapshots of any incidents for archiving. With the recent upgrade to include USB port backup, users can now include removable (external) backup drives. Time and date stamp encrypts backed up files to keep original authenticity.

WatchNET E-Series dvr contains complete plug and play functionality. Our Camcorder menu is easy to follow and understand. Setup can be done in its entirety through network connection; also elements of programming can be done both locally or through the Internet.

WatchNET E-Series dvr includes a built in web server and allows DNS for remote access. The H.264 hardware compression allows users to operate at a lower bit rate, which dramatically enhances network streaming and storage capacity. Due to this increase in network speed, users can now remotely view live video / audio playback previously recorded video / audio at the same time. Also with our versatile custom display, users have the option to view and playback cameras from the dvr simultaneously.

WatchNET's optional Text Inserter, overlays critical text data from an ATM or POS bay. By taking the text feed from either of these modules users can link video and data. This will dramatically cut down on fraud and ultimately, increase sales and profits.

One of **WatchNET**'s most recent developments includes our Central Server software. This application software can connect over 100 sites at the same time. This software was developed for clients wanting to view multiple locations/sites. This software is licensed for corporate from a central location and monitor alarms video loss etc.

WatchNET E-Series dvr has a "Smart HDD Management" tool that will recognize failed HDD'S or "bad sectors" on a HDD. Upon finding these sectors the system will isolate them and continue recording to the appropriate functional sectors. For those users who require additional hard drive space, Watchnet has a completely automated HDD upgrade feature. All the user needs to do is simply power down system, plug in new hard drive and turn system back on. The dvr will simply recognize the additional drive space and automatically configure device for recording, maximum 1.5 terabytes / system.

These and other features have made **WatchNET** E-Series dvr the right choice for a conscientious consumer in today's security environment.

Performance Delivered

WATCHNET DVR

SPECIFICATIONS

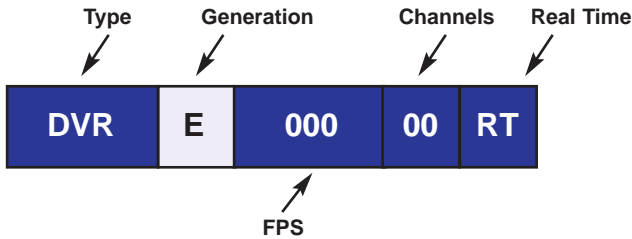

Model Reference Chart

Storage:

Internal: 80 - 120 - 200 - 250 GB
 Expandable to 6 Internal storage
 HDD's to a maximum of 1.5 TB

Image resolution:

Real time monitor 704 x 576
 Playback 352 x 288
 Vga output 720 x 576

Record Rate (IPS):

NTSC: 480 total, configurable per camera:
 30, 15, 10, 7.5, 6, 5, 4, 3, 2, 1, 0
 PAL: 470 total, configurable per camera:
 25, 12.5, 8, 6, 5, 4, 3, 2, 1, 1/2, 1/5, 1/10, 0

Recording resolution:

NTSC: 480 total, configurable per camera:
 30, 15, 10, 7.5, 6, 5, 4, 3, 2, 1, 0
 PAL: 470 total, configurable per camera:
 25, 12.5, 8, 6, 5, 4, 3, 2, 1, 1/2, 1/5, 1/10, 0
 720 x 288 PAL - 720 x 242 NTSC

Display Modes:

Mon A: Full, quad, sequence, multi-screen,
 alarm call-up (live and playback)
 Mon B: Full, full sequence and alarm call-up

Video Recording Speed:

Real -time mode:
 NTSC: 1 f/s - 30 f/s for each channel adjustable
 PAL: 1 f/s - 25 f/s for each channel adjustable

Write speed DVD writer:

- DVD+RW/DVD+R: 4 x (or higher)
 - CD-RW/CD-R: 16 x (or higher)

Supported media: DVD+R, DVD+RW, CD-R, CD-RW

Dimensions:

2 U standard industrial case
 441mm (Wide) x 430 (Deep) x 89 (High) mm
 17.32 in x 16.92 in x 3.50 in

Weight:

Approx: 11 kg / 22 lbs
 Rack Mount Kit (Included):
 For mounting one unit in an EIA 19-inch rack

Rated Voltage and Power:

110-220 VAC;
 Power consumption: 75 W

Video:

NTSC: 525 lines 60 f/s
 PAL: 625 lines 50 f/s
 Resolution:
 VGA: 1024 x 768
 NTSC: 740 x 480
 PAL: 720 x 576
 Compression: H264 4 CBR (fixed frame rate)
 H264 4 VBR (variable frame rate)
 Compression Rate: 352X288CIF format, 176X144QCIF format
 704X576 4CIF format
 Inputs: Composite video 0.5-2Vpp,
 75-ohm auto terminating
 Outputs: 1Vpp, 75 ohm

Audio:

Inputs: 4, 8 or 16 RCA
 - ADPCM 28.8 Mb/hour G.729
 - 3.6 Mb/hour Video - 40- 460 Mb/hour

Alarm Handling:

Inputs: 4, 8, 12 inputs configurable
 NO/NC, max.
 Input voltage 30 VDC 1A
 Outputs: 3 at 125 VAC 0.5A

Control:

RS485

Connectors:

Video inputs: 4, 8 or 16, auto-terminating BNC
 Audio inputs: 4, 8 or 16, RCA
 Ethernet: RJ45 10M/100M

Number of Disks:

Inside equipped 4 ide ports, able to
 support 6 internal HDD of any size and 1
 CD / DVR RW

Performance Delivered

Environmental

Temperature:

- Operating: +10°C to +55°C (+50°F to +131°F)

Relative humidity:

- Operating: 10% - 90% Non-condensing

Barometric pressure: 86 kpa - 106kpa

Electromagnetic Compatibility

EMC requirements:

- USA: **CE FC** Part 15, Class B

Minimum System Requirements

For Remote Monitoring

Operating system: Windows 2000 or XP

Processor: Pentium 4 or Higher

RAM memory: 256/512 MB

Video system: 64 MB video memory, 800 x 600 with

32-bit color

Connection: LAN / WAN / DSTN



COMPLETE STAND-ALONE SYSTEM

This stand-alone configuration shows typical set up of a system:

- 1 to 16 Cameras
- Spot Monitors
- Call monitors
- PTZ Camera and Control
- Remote Control
- ATM / POS Connection
- Remote Monitoring



MULTI-LOCATION WITH CENTRALIZED CONTROL

This application software requires that each location have a local dvr system and that all locations be connected via a local or wide area network (LAN or WAN). A PC with the central server software can then connect for remote observation; download recorded files with audio or system management. When further surveillance is required an optional text inserter for ATM or Point Of Sale is connected to the dvr, searching for video linked to the transaction data can be performed locally or via the network.

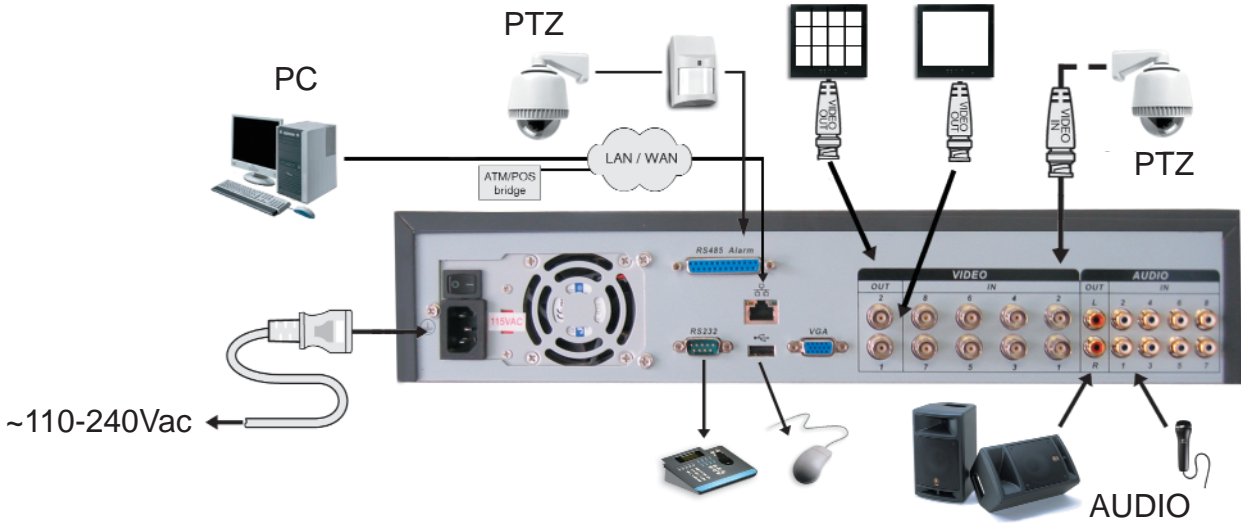

Performance Delivered

WATCHNET DVR